

ECO500WBV1BLK

Product description: upright WB 500 litre rectangular baffled water tank, suitable for internal or external use

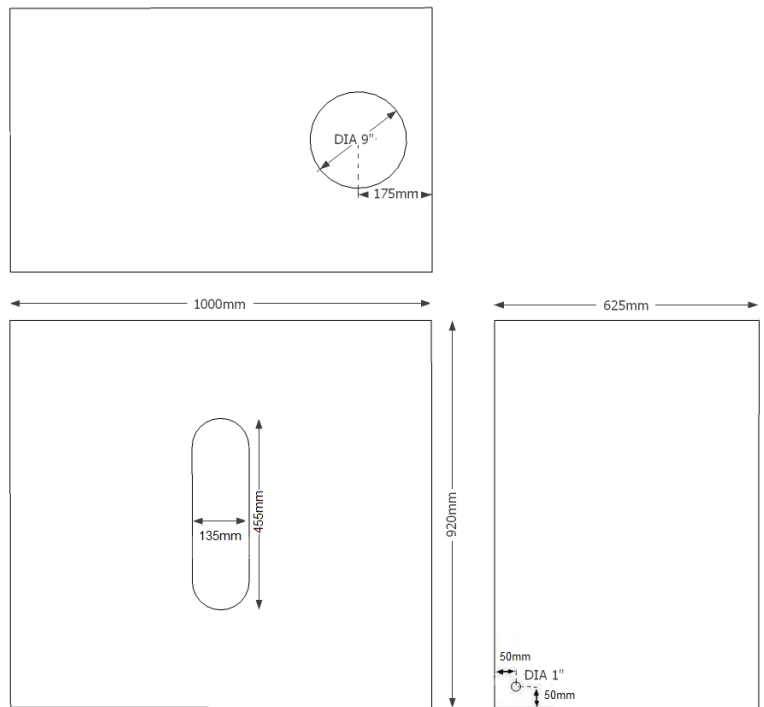

Product Information					
Height	Length	Width	Weight	Outlet	Lid
920mm	1000mm	625mm	33kg	1" BSP	9" screwdown

Sizes approximate, owing to shrinkage

PRODUCT DETAILS:

- Made from virgin polymer
- 9" vented lid as standard
- 1" brass threaded outlet moulded into the tank
- Central baffle

OPTIONAL EXTRAS:

- Brass tap
- Brass isolation valve with hose connector
- Tank connectors
- Stainless steel inserts

BENEFITS:

- Suitable for internal and external use
- Frost proof; will not crack in the cold
- Baffle prevents deformation when tank is full
- Opaque plastic reduces algae growth in sunlight
- Compact, stable design
- Rotationally moulded for strength and durability
- 1 year warranty against manufacturing defects



Scan to view our full range of water tanks



Etills Ltd
Unit 1 Whiting Way,
Melbourn,
Royston,
SG8 6NA

Tel: 01763 261781
Fax: 01763 268409

This specification may be subject to change without notice; please call to confirm details.